

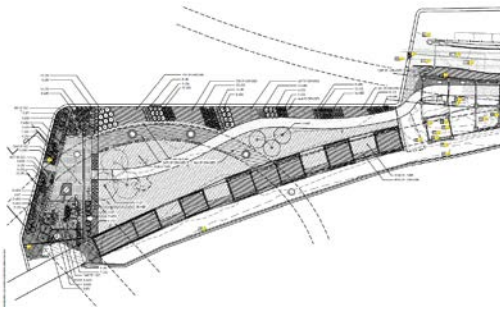

## GREEN STREETS | GREEN JOBS | GREEN TOWNS INITIATIVE

The Green Streets, Green Jobs, Green Towns Partnership (G3) aims to stimulate the green jobs market and enable families to work where they live and play. Small to mid-sized communities can boost their local economies and protect water resources through the use of watershed planning, design and construction of stormwater best management practices.



### Completed Project Metrics



2,625 sq. feet of pervious surface installed



1,707 native plants installed



975 pounds of trash removed



8,100 sq. feet of reforestation area created



1,419 hours of volunteer service among community members



The Mary Morton Parsons Foundation



waterstreetstudio

### Capital Trees' Low Line Project in Richmond, VA

for bioretention and native plantings in the riparian buffer as part of the Low Line Project in Richmond, Virginia.

The Low Line Park completed Capital Trees' signature Low Line project, restoring 5.5 acres of previously neglected and untended land. The Low Line Park is uniquely situated at the western end of the Virginia Capital Trail, serving as a gateway to the City of Richmond. Overhead stretches the CSX viaduct that carries coal and agricultural products, and Interstate 95. The site represented a tremendous opportunity to treat storm water runoff from the interstate bridges, prior to its deposit into the Canal and James River. This public land has important historic, environmental, social and economic attributes and sits within the footprint of the 2012 Richmond Riverfront Master Plan.

In 2015, Capital Trees was granted permission to renovate and create an open green space on this land that is adjacent to the Kanawha and James River Canal and to create a linear park between the floodwall at 17th Street and Great Shiplock Park at Pear Street. In Phase I of the Low Line, three of the 5.5 acres were restored as the Low Line Gardens,

installing new plants, shrubs and trees to serve as a great riparian buffer along the sensitive James River watershed, including storm water mitigation amenities, native plants and pollinators.

The Low Line Park was Phase II of the Low Line and completed the restoration and reinvention of 5.5 acres of open space in Richmond's urban core. The design of the Low Line Park includes active and passive storm water management, an outdoor classroom/plaza for formal and informal social interaction, irrigation for the new plantings, improved lighting for safety and an extensive horticultural park using native plantings and pollinators.

The Low Line created an urban green space for the community where none had existed before. Both active and passive storm water management is on display for the estimated 100,000+ annual visitors to the site, with added signage to educate these visitors on the role both play in improving the water quality of the James River.

# PROJECT ELEMENTS

- Impervious pavement removal** – Rain hits impervious surfaces such as concrete, parking lots and roads, and because it cannot soak through, it instead runs off into storm drains or directly local waterways. This project removed 1,275 square feet of impervious surface. An additional 12,598 square feet of impervious surface was treated, and 2,625 square feet of pervious surface, such as porous pavement and native plants, was installed.
- Native Plants** – Native plants offer numerous benefits. Because native plants are adapted to local environmental conditions, they require far less water. They provide vital habitats for birds, insects and other species of wildlife, prevent water run-off, and improve air quality. This project planted over 1,700 native plants, contributing to the area’s healthy soil and water.

Year Awarded:	2018
Award Amount:	\$75,000
Match Funds:	\$300,389

## Before and After Site Photos



## SUSTAINABILITY & GROWTH: ADDITIONAL GREEN ACTIVITIES

The Low Line’s 5.5 acres were in the footprint of the 2012 Richmond Riverfront Master Plan (RRMP). Richmond City Council adopted this Plan in November 2012 as a part of the City’s Master Plan and Downtown Plan. The Plan recognized the James River as an unparalleled natural and cultural resource, unique to Richmond and critically poised to catalyze both growth and conservation at the core of the City. The Low Line Park demonstrates the critical role that green infrastructure should have in a community’s creation and restoration of green open space.

The RRMP is a transformative and comprehensive vision for the future of the downtown Richmond Riverfront. The Downtown Plan promotes the James River as Richmond’s “great, wet Central Park.” The ultimate objective of the Plan is to allow residents and visitors to fully enjoy this unique natural feature by creating a series of clear connections to the riverfront. Expanded use and access is accompanied by significant social, ecological and economic improvements that are both quantitative and qualitative.

The RRMP redefines the City-River relationship, dramatically expanding both visual and direct physical access to the James River. The long-term vision for the Richmond Riverfront is a sustainable public landscape corridor seamlessly connected with the River’s significant resources upriver and downriver, and a reaffirmed focus on the James River as the heart of the Richmond region.



**Project Partners:** Alliance for the Chesapeake Bay, Chesapeake Bay Trust, City of Richmond, Mary Morton Parsons Foundation, Stockbridge Companies, U.S. Environmental Protection Agency, Waterstreet Studio